

# 18<sup>TH</sup> CENTURY: GOLD AND SILVERWARE - FURNITURE

## 2<sup>ND</sup> HOUSE • 1<sup>ST</sup> FLOOR

### ROOM 9

18<sup>th</sup> century

*drawing-room, Louis XV and Louis XVI furniture.*

In the 18<sup>th</sup> century the drawing-room was often used for social gatherings and this can explain why seating evolved towards styles ensuring both comfort and utility, as is seen in card or *bouillotte* tables and in *duchesses brisées*, chairs which allowed ladies to receive their visitors reclining.

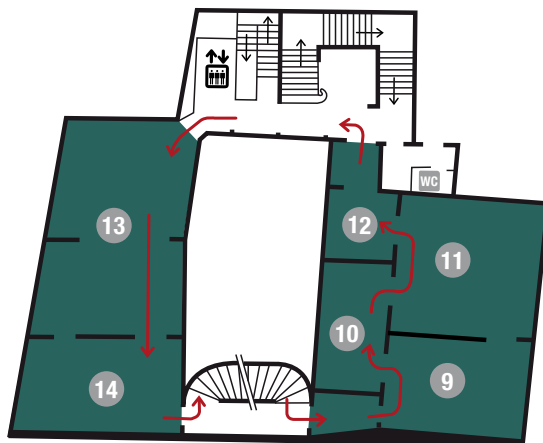

→ A description of the furniture on display is available in the room.

### ROOM 10

Gold and silverware for private use

16<sup>th</sup> to 18<sup>th</sup> century.

This collection is one of the most interesting to be housed in a provincial French museum. It includes some foreign pieces of exceptional quality: a late 16<sup>th</sup> century Spanish water pitcher, a pair of 17<sup>th</sup> century Tournai candlesticks, an Augsburg goblet from the 17<sup>th</sup> century. There are also 18<sup>th</sup> century Parisian and provincial works: Avignon ewers, a Dijon coffee pot, a Perpignan oil and vinegar set, a vegetable dish from Montpellier. Many Auvergnat pieces are displayed too: goblets, tasters, bowls and knives from Riom, Clermont-Ferrand, Saint Flour, Issoire, Thiers and Moulins.



**water pitcher** - Spain - Argent  
Late 16<sup>th</sup> century.



**Covered Drinking Bowl**  
Clermont-Fd  
Silver - 1781

### ROOM 11

18<sup>th</sup> century drawing-room,

*Louis XV and Louis XVI furniture.*

A reconstitution of an 18<sup>th</sup> century drawing-room. In the middle, a « coffin-shaped » commode chest of drawers marked Birckle and, on the right, a roll-top desk marked Schlichtig.

→ A description of the furniture on display is available in the room.



« Coffin-shaped » commode - 18<sup>th</sup> century.